



-Glendora to Pomona-

NOTICE: Full Street Closure

GREVILLIA ST. BETWEEN GAREY AVE. & PINE ST. (CITY OF POMONA)

JANUARY 6 - 10, 2025

CONSTRUCTION ACTIVITY

As part of the 9.1- mile Foothill Gold Line light rail project, crews will grind, repave and stripe Grevillia St. between Garey Ave. and Pine St. as part of the Garey Ave./Grevillia St. intersection operations. This work will require a full closure of Grevillia St. and take place in both the eastbound and westbound lanes taking place during daytime operations. Business and Metrolink access will be maintained via Pine St.

WHEN

Beginning Monday, January 6th, 2025, Grevillia St. will be fully closed to all thru traffic (vehicular and pedestrian) between Garey Ave. and Pine St. Arrow Hwy. (south of the closure area) and Santa Fe St. (north of the closure) will remain open and accessible. Detour routes shown below, see map.

- Daily work hours: 7:00 AM - 8:00 PM. NOTE: Occasional longer work hours may be performed during the closure period if required.

TRAFFIC ADVISORIES

- Grevillia St. will be fully closed to vehicular and pedestrian traffic north of Arrow Hwy. and south of Santa Fe St. and Bonita Ave.
- Access to businesses within the closure area on Grevillia St. will be maintained at all times via Garey Ave. and Pine St.

PLAN YOUR ROUTE AND BE PREPARED

- A detour route (see map below) will be in place during the closure and signage will be posted to direct motorists and pedestrians as well as Metrolink customers. Please follow detour signs.
 - ✓ Grevillia St. will be fully closed to all thru traffic at Garey Ave. north of Arrow Hwy.
 - ✓ Pine St., Garey Ave., & Fulton Rd. (northbound and southbound) will remain open to all traffic.
 - ✓ Arrow Hwy. (eastbound and westbound) will serve as the main detour route, see details below.
 - ✓ Santa Fe St. & Bonita Ave. (eastbound and westbound) will remain open to all traffic.

NOTE TO RESIDENTS / BUSINESS OWNERS

- Noise from construction equipment will be produced near the active work zones.
- Bus stops may be temporarily relocated, for more information:
 - ✓ Foothill Transit Bus: (800) RIDE-INFO/ (800) 743-3463 or foothilltransit.org

STAY SAFE

Please obey all posted construction signs and do not enter the construction work zone.

Para información en español por favor llame o envíe un mensaje de texto a (626) 513-5788.

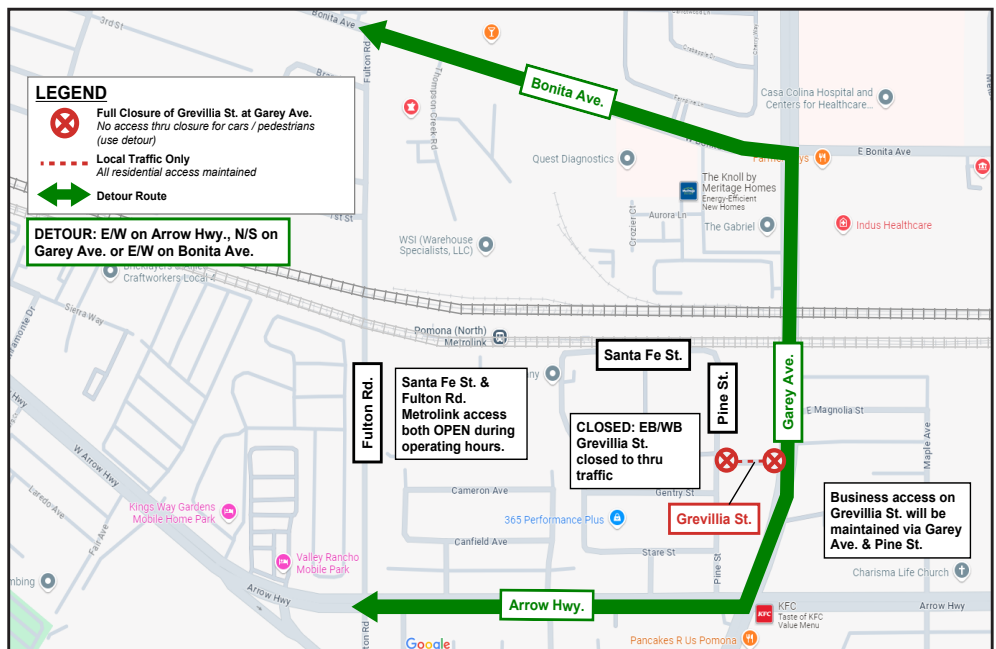

QUESTIONS?

Project Construction Questions Hotline: (626) 513-5788 **Email:** CommunityRelations@Kiewit-Parsons.com

General Project Questions: (626) 471-9050 **Email:** PublicAffairs@Foothillgoldline.org

Stay ahead of construction, sign up for alerts: www.foothillgoldline.org

**Construction schedules are subject to change for various reasons, including, but not limited to, weather conditions and unforeseen delays.*